

### Corrigendum

Subject:- Clarifications sought through CPP Portal

Name of Work:- Request for proposal (RFP) for Concession to design, fit-out, finance, develop, market, operate, maintain and manage the Retail Outlets at Shaheed Bhagat Singh International Airport, Chandigarh

Sr. No	Query	Reply
1.	<p>Are the current or existing Retail outlets considered in this tender. If not considered, what would be the total number of outlets.</p> <p>ii. What are the current categories or brands being retailed.</p>	<p>14 Nos. of Standalone Retail outlets are currently operating at the airport with an area admeasuring 233 sqm in Domestic SHA. Layout of current retail outlets is enclosed below at page no 7.</p> <p>Total assigned area under the Master Concession is 1213 sqm in Arrivals, Domestic SHA and Int'l SHA.</p> <p>May refer, Concessioned Premises Layout Plan - Schedule - A and Schedule - C for details.</p> <p>The categories currently being retailed are Personal Care products, Cosmetics, fragrances, Destination merchandise, Bags, Leather Goods, Footwear, Leather Accessories, Men/Women/Kids Apparel &amp; Fashion wear, Electronics products, Confectionary, Sweets, candies, packaged water, Snack in sealed aseptic pack, Gifting Items, Toys</p> <p>Bidders may visit the Airport for Physical Inspection of Concessionaire Managed Locations with prior intimation to Authority for better understanding.</p>
2.	Can the spaces in the RFP be divided into multiple outlets and or combined to make outlet	To be governed as per Schedule L of RFP, Page No 202.
3.	Can the bidder bid only for the Domestic or International or Arrivals.	No, the bidder has to bid for the total assigned area under the Concession i.e. 1213 sqm.

4.	Are there other outlets in the Kerbside or Checkin Area. If so how many and what categories and brands are being retailed.	Retail outlets are currently being operated in domestic SHA only.
5.	Can the bidder bring in categories or brands not specified in RFP	Brands not falling within the indicative list provided under Appendix-V, may also be considered and permitted by Authority at post award stage at its sole discretion, to which bidder / concessionaire must obtain approval / permission of Authority in writing within business incubation period.
6.	Need dwgs for the pax flow in Domestic, International and Arrivals	Data not available
7.	Need dwgs and locations of existing Retail and Food and Beverage Outlets	Layouts enclosed below at page no 7 and 8.
8.	What is the warehousing space available and the rentals for the same	Service area may be provided subject to availability and as per approval of the Competent Authority.  "Service Area(s)" shall mean any kitchen area, storage area, record room, etc. (which may be located within or outside passenger terminal building) as Authority may allow access to pursuant to the grant of Concession and accepted by the Concessionaire in relation to implementing the Concession.  For space rentals, may please refer Article 14 page no 152.
9.	What percentage of store space can be taken for BOH	Service area may be provided subject to availability and as per approval of the Competent Authority.  "Service Area(s)" shall mean any kitchen area, storage area, record room, etc. (which may be located within or outside passenger terminal building) as Authority may allow access to pursuant to the grant of Concession and accepted by the Concessionaire in relation to implementing the Concession.  For space rentals, may please refer Article 14 page no 152.
10.	Can we propose hybrid concepts like adding packed foods or fast-moving goods as a part of retail offering	No, The Concessionaire shall only retail / sell the items at the retail outlets in the Airport as per clause 5.2.5 of RFP page no. 46.

कॉर्पोरेट कार्यालय: नई सिविल एयर टर्मिनल, झुरेरी, मोहाली (पंजाब) 140306

Corporate Office: New Civil Air Terminal, Jhurheri, Mohali (Punjab) 140306

Tel No.: 0172-2242016, Fax No. 0172-2242003, email: hodcommercial@chial.org, website: chial.org

CIN U63013CH2010GOI031999

11.	Can we sub-lease the locations	May refer RFP Pg No 170, Article – 21, Clause 21.4
12.	Are there any cam charges applicable? If yes, then please let us know the charges.	May please refer Article 14, page no 152.
13.	What proportion of pax depart from the Bus Gate and aerobridges	Approximately 50-60 % aircrafts use aerobridge
14.	How many pax are departing from and to Chandigarh Airport. Please share the details of gate utilisation.	Pax data may be taken from AAI website. Gate utilisation data not available.

### Clarifications sought through email:

Sr. No.	Queries	Reply
1.	<b>Flight &amp; Passenger Data:</b>	
	Current load factors for different sectors and airline split.	Data not available
	Flight timings for the 41 flights.	As per attachment below at page no. 6
	Passengers mix for international flights.	Data not available
2.	<b>Sales &amp; Retail Performance:</b>	
	Current sales of the 14 stores, along with product category breakdown.	Data not available
	Current sales data for the Duty-Free \ (DF\ ) area, with category-wise details.	Data not available
3.	<b>Financials &amp; Expenses:</b>	
	Is CAM included in the ₹50L rent from the 14 retailers, or is it separate?	Concession fee of currently operated 14 retail outlets is approx. Rs. 47.74 Lakhs (excluding CAM & GST.)
	Any additional expenses to be borne \ (e.g., utilities\ )?	May please refer Article 14, page no 152.
	Breakdown of the ₹50L current rental split.	Concession fee of currently operated 14 retail outlets is approx. Rs. 47.74 Lakhs and CAM Charges approx. Rs.91,000/- plus 18% GST.
	CAM charges – is it 10% of space rent or ₹1,250/sqm? How much are the current incumbents paying?	May please refer Article 14, page no 152.
4.	<b>Infrastructure &amp; Planning:</b>	
	Any Capex incurred by the airport currently?	Only bare space was provided to the Licensees operating standalone Retail Outlets.

	Is 1,212.3 sqm considered Phase 1? What is planned for Phase 2? \ (Clouse no 5.6.2 Schedule E page no 186\)	Gross floor area is 1,213 sqm for the concession period of 7 years.  May please refer Clause 5.6.2, page no 49.
	Location details of the 14 current stores \ (e.g., R02, RK1, etc.\).	Layout enclosed below at page no 7
	Common area to be considered for QMG calculations \ (B3\).	Question not clear.
<b>5.</b>	<b>Tender &amp; Lease Terms:</b>	
	Lock-in period and current Security Deposit \ (SD\ ) of the 14 incumbent stores.	Lock-in period is 50% of the contract period.  SD amount is equivalent to 6 months of License Fee.
	Tender timelines - when will we get the handover? From that point, do we have four months before MMG payments start?	As per RFP
	Checklist of schedules we need to submit \ (e.g., Proposal on Customer Service, etc.\).	As per RFP



# चंडीगढ़ इंटरनेशनल एयरपोर्ट लिमिटेड

## Chandigarh International Airport Limited

SHAHEED BHAGAT SINGH INTERNATIONAL AIRPORT CHANDIGARH, WINTER FLIGHT SCHEDULE - (01-FEB- 2025 TO 29-MAR-2025)							
SL NO.	AIRLINES	FLIGHT No.	DOOP	ARRIVAL FROM	ARRIVAL TIME	DEPARTURE TO	DEPARTURE TIME
1	IndiGo	6E2315/6056	123457/6	BASE	BASE	DELHI/GOA	0545/0635
2	IndiGo	6E5261	1234567	BASE	BASE	MUMBAI	0555
3	IndiGo	6E0867/2315	123457/6	BASE	BASE	HYDERABAD/DELHI	0620/0545
4	IndiGo	6E146.	1234567	BASE	BASE	LUCKNOW	0710
5	IndiGo	6E242/971	1234567	PUNE	0600	CHENNAI	0720
6	IndiGo	6E6394	1234567	BASE	BASE	PATNA	0730
7	IndiGo	6E7742/7743	123456	JAIPUR	0625	JAIPUR	0645
8	AIR INDIA	AI437/438	1234567	DELHI	0700	DELHI	0740
9	IndiGo	6E6633/6634	1234567	BENGALURU	0740	BENGALURU	0815
10	AIR INDIA	AI619/620	7	MUMBAI	0745	MUMBAI	0820
		AI2653/2654	123456	MUMBAI	0820	MUMBAI	0900
11	IndiGo	6E2316/6056	123456	DELHI	0835	GOA (GOX)	0910
12	IndiGo	6E1417/1418	1356	ABU DHABI	0855	ABU DHABI	1015
13	AIR INDIA	AI457/458	26	LEH	0950	LEH	1020
14	AIR INDIA	AI3415/3416	246	LEH	1005	LEH	1035
15	IndiGo	6E0959/6738	1356	INDORE	1050	INDORE	1215
16	IndiGo	6E6375/112	12456/3.	AHMEDABAD	1110/1245	DELHI	1140/1315
17	IndiGo	6E291/293	246	LEH	1115	LEH	1145
18	IndiGo	6E7718/7719	1245/36.	JAIPUR	1120	JAIPUR/DHARAMASALA	1200
19	IndiGo	6E5262/5263	123456	MUMBAI	1200	MUMBAI	1240
20	AIR INDIA	AI413/414	123456	DELHI	1235	DELHI	1340
21	IndiGo	6E262/6352	123456	SRINAGAR	1245	SRINAGAR	1410
22	IndiGo	6E108/2195	123456	HYDERABAD	1250	DELHI	1330
23	IndiGo	6E6005/614	1234567	CHENNAI	1355	GOA	1430
24	IndiGo	6E7722/7721/7517	1245/36.	DHARAMASALA	1420/1445	DHARAMSALA/JAIPUR	1440/1535
25	AIR INDIA	AI2657/2658	1234567	BENGALURU	1435	BENGALURU	1510
26	AIR INDIA	AI2706/2403	1234567	DELHI	1450	DELHI	1530
27	IndiGo	6E1482/1481	1234567	DUBAI	1510	DUBAI	1610
28	IndiGo	6E7516/7517	12457	JAIPUR	1515	JAIPUR	1535
29	IndiGo	6E6015/6254	1234567	GOA	1520	HYDERABAD	15:55
30	IndiGo	6E6552/2267	1234567	LUCKNOW	1530	DELHI	1610
31	IndiGo	6E6485/429	1234567	PATNA	1550	BENGALURU	1630
32	INDIAN RAIL ALLIANCE AIR	91323/324	1	DELHI	1605	PRAYAGRAJ	1630
		91325/326	3	PRAYAGRAJ	1925	DELHI	1950
33	IndiGo	6E2196/6203	1234567	DELHI	1610	MUMBAI	1640
34	IndiGo	6E874/874	123456/7	KOLKATA	1640	SRINAGAR/KOLKATA	1710/1720
35	AIR INDIA	AI2659/2660	1234567	MUMBAI	1715	MUMBAI	1750
36	IndiGo	6E5178/2113	1234567	MUMBAI	1815	DELHI	1845
37	IndiGo	6E2354/2353	13456	PRAYAGRAJ	1820	PRAYAGRAJ	1100
38	IndiGo	6E851/593	1234567	BENGALURU	1825	BENGALURU	1855
39	AIR INDIA	AI841/842	1234567	DELHI	1830	DELHI	1920
40	IndiGo	6E2268/6395	1234567	DELHI	1845	AHMEDABAD	1915
41	AIR INDIA	AI615/616	1234567	MUMBAI	1910	MUMBAI	1945
42	IndiGo	6E6041/6041	1234567	SRINAGAR	1950	KOLKATA	2053
43	INDIAN RAIL ALLIANCE AIR	91323/324	1	DELHI	1140	DELHI	1205
		91325/326	3	DELHI	2035	DELHI	2100
		91831/832	7	DELHI	2045	DELHI	2110
44	IndiGo	6E7414/7413	1234567	JAIPUR	2035	JAIPUR	2105
45	IndiGo	6E724/681	1234567	GOA	2045	PUNE	2205
46	AIR INDIA	AI2637/2638	1234567	DELHI	2200	DELHI	2230
2	IndiGo	6E2194	1234567	DELHI	2205	BASE	BASE
3	IndiGo	6E6204	1234567	MUMBAI	2225	BASE	BASE
1	IndiGo	6E6252	1234567	HYDERABAD	2240	BASE	BASE
7	IndiGo	6E6385	247	BENGALURU	2315	BASE	BASE
4	IndiGo	6E6506	1234567	AHMEDABAD	2325	BASE	BASE
For any revision/cancellation/amendment or for any query in above schedule, please intimate ATM Office, CHIAL at least 5 days in advance.							
MOBILE NO :--- 9501014832, Email ID - airportmanager@chial.org							
No Change in allotted bays without prior approval from ATM Office						*BASE FLIGHTS	*ATR



### Layout of current retail outlets

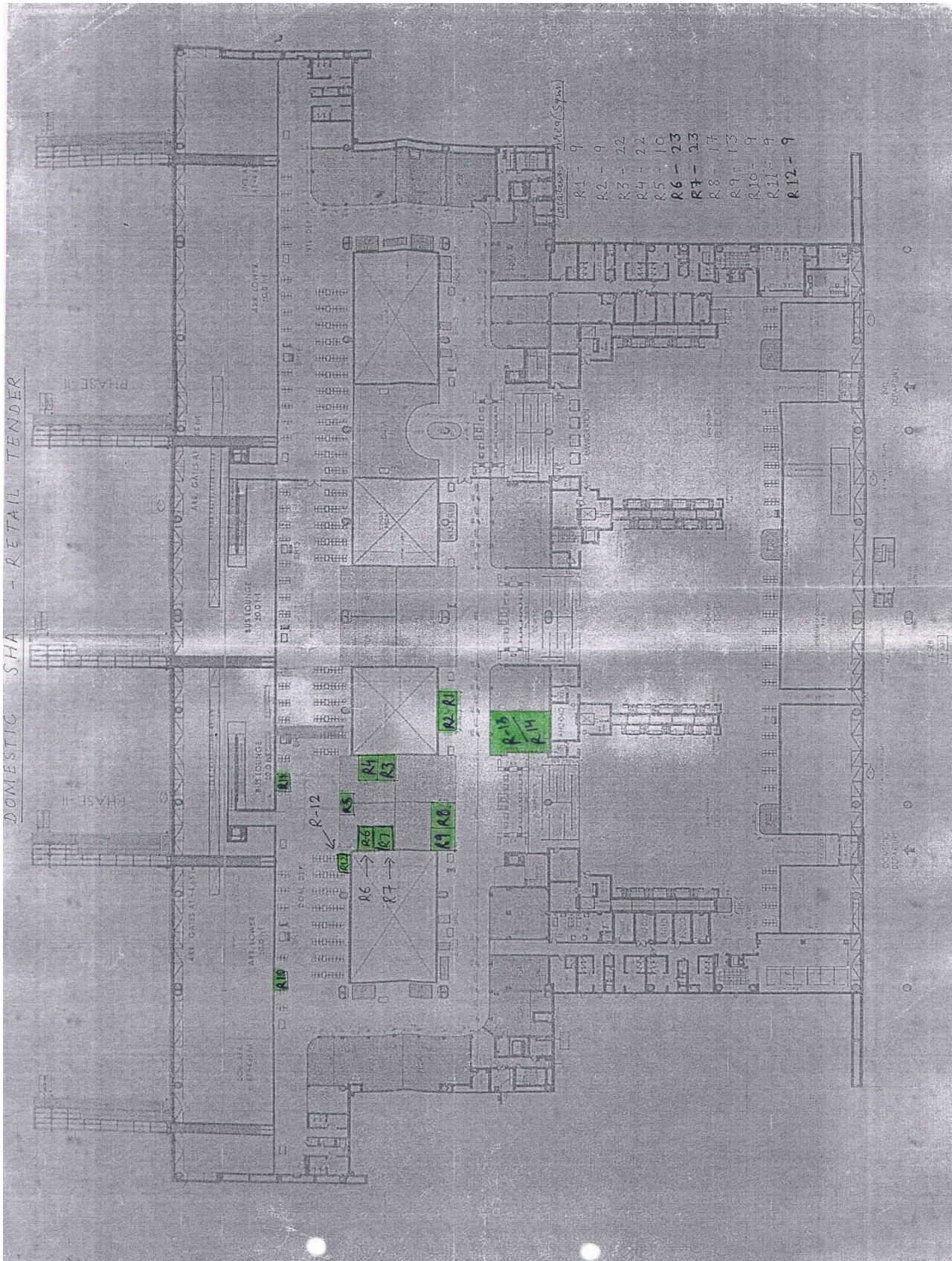

ਕਾੱਪੋਰਿਟ ਕਾਰ્યાਲਯ: ਨਵੀਂ ਸਿਵਿਲ ਏਯਰ ਟਰਮਿਨਲ, ਝੁਰੇਰੀ, ਮੋਹਾਲੀ (ਪੰਜਾਬ) 140306

Corporate Office: New Civil Air Terminal, Jhurheri, Mohali (Punjab) 140306

Tel No.: 0172-2242016, Fax No. 0172-2242003, email: [hodcommercial@chial.org](mailto:hodcommercial@chial.org), website: [chial.org](http://chial.org)

CIN U63013CH2010GOI031999



Layout of current F&B Outlets

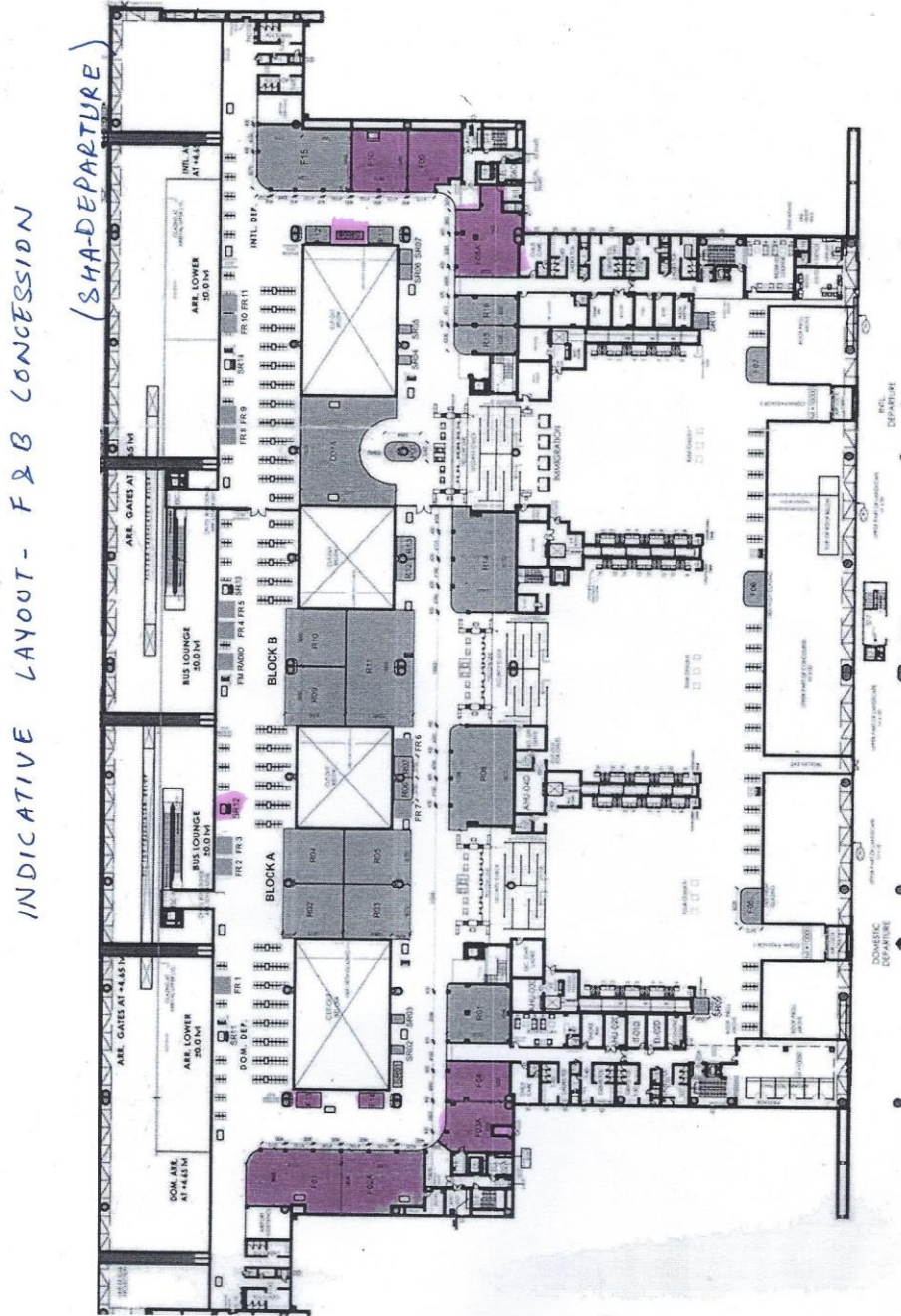

Bid Manager  
For Chief Executive Officer  
Chandigarh International Airport Limited